

# 619 Series

## Narrow Style Door Activator Switches

## INSTALLATION INSTRUCTIONS

### Section 1

#### General Description

The 619 series door activator switches are designed to provide unobtrusive, reliable activation of any automatic door at the doorframe. The unique design of these switches includes interchangeable face plates that attach to a 1 11/16" x 4 1/2" stainless steel back plate assembly. The face plates are available in different finishes and legends (contact the factory for more information)

### Section 2

#### Basic Installation

- 1) Make the required cutout in the door frame.

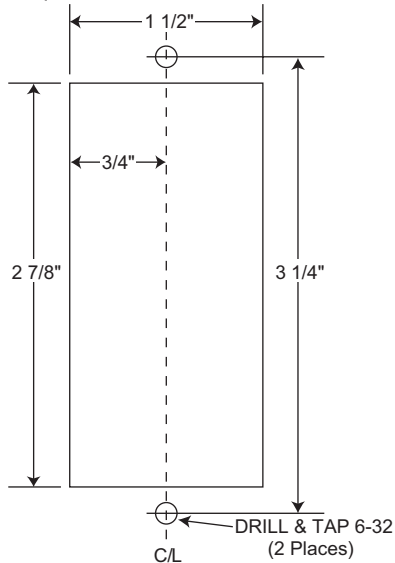

- 2) Remove the face plate from the back plate assembly.
- 3) Connect the necessary signal wires to the appropriate switch contacts on the micro-switch—standard connections are COM and N.O.

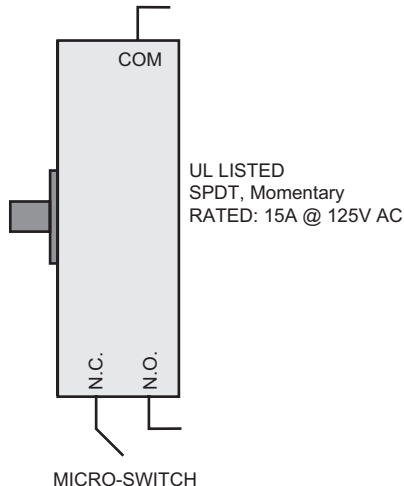

- 4) Attach the back plate assembly in the cutout prepared in step 1 with the 6-32 x 1" screws provided. **Do Not Over Tighten!**

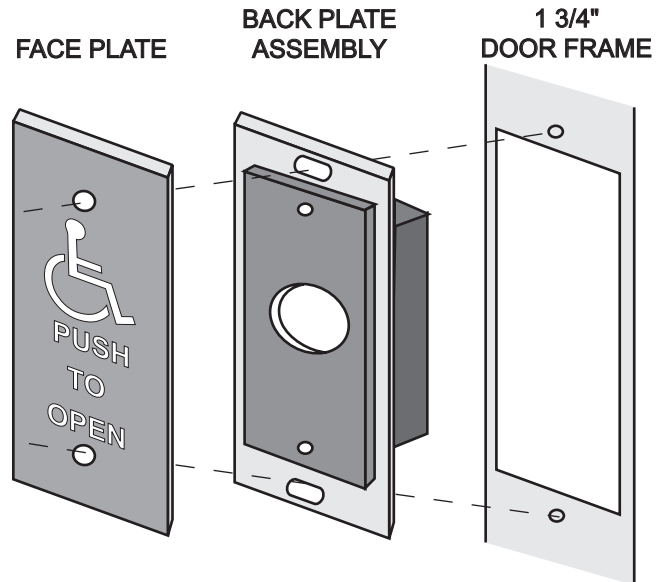

- 5) Reinstall the face plate.



NOTICE: For surface mounting applications, order the 1106 surface mount box.



NOTICE: For radio control applications, order the TX-708 transmitter with surface mount box.



NOTICE: For applications where a greater level of weather protection is desired, order either the RB kit or WR kit.

For further technical assistance, contact the factory at 1-800-842-2545.